

# ENGINE & HYDRAULIC PUMP MOUNT

(2/83)

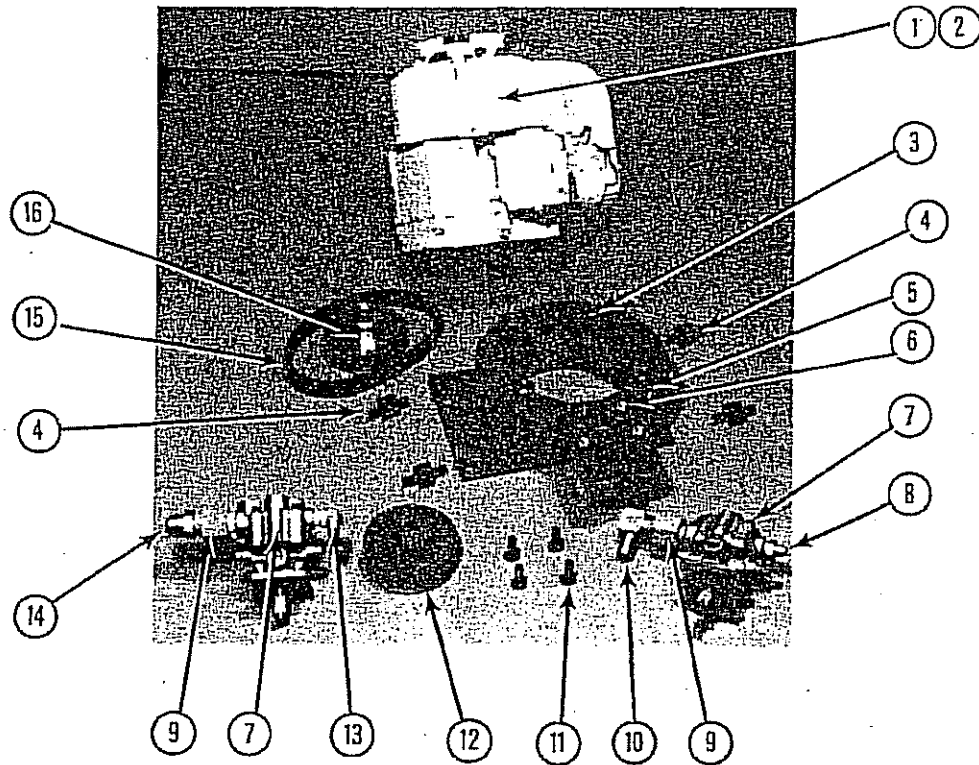

NO.	NUMBER	DESCRIPTION	REQ'D
1	525-142	Engine, Propane	1
2	525-142R	Engine, Propane, Rebuilt	1
3	550-484	Spacer, Engine Mount	4
4	525-241	Vibratory Isolator Start S/N F-8784	4
5	525-165	Base, Pump & Engine Mount	1
6	606-452	Nut, 3/8-16, Lock Type	4
7	607-850	Pump, Hydraulic	1
8	550-239	Male conn. 3/8 JIC x 3/8 NPT	1
9	525-109	Adapter, 1/2 NPT, Male x 3/4 NPT, Female	1
10	525-110	90° Male Elbow, 3/4 NPT x Push On	1
11	525-178	Capscrew, Flathead Socket, 3/8-16 x 1 1/4 Lg.	4
12	525-162	Sheave, Hyd. Pump, with Taperlock & Bushing	1
13	550-195	90° Male Elbow, 3/8 JIC x 3/8 NPT	1
14	606-437	Male Conn. 3/8 JIC x 3/4 NPT	1
15	525-163	Belt, Timing	1
16	525-175	Sheave, Engine	1